

MIXTURE CONTROL SOLENOIDS

◆ DESCRIPTION

BASED ON CHANGING INPUTS FROM SENSORS SUCH AS MAP & OXYGEN SENSOR THE COMPUTER CHANGES PULSE WIDTH SUPPLIED TO THE MIXTURE CONTROL SOLENOID. THE SOLENOID THEN LEANS OR RICHENS THE CARBURETOR MIXTURE AS NEEDED

◆ SYMPTOMS OF FAILURE

TYPICAL SYMPTOMS OF A FAILED SOLENOID WOULD BE RICH MIXTURES, CATALYST ODOR, "CHECK ENGINE LIGHT", AND NO START CONDITIONS

◆ RECOMMENDED SERVICE

CHECK FOR PROPER OPERATION, REPLACE WHENEVER CARB IS REPAIRED

TYPICAL LOCATION

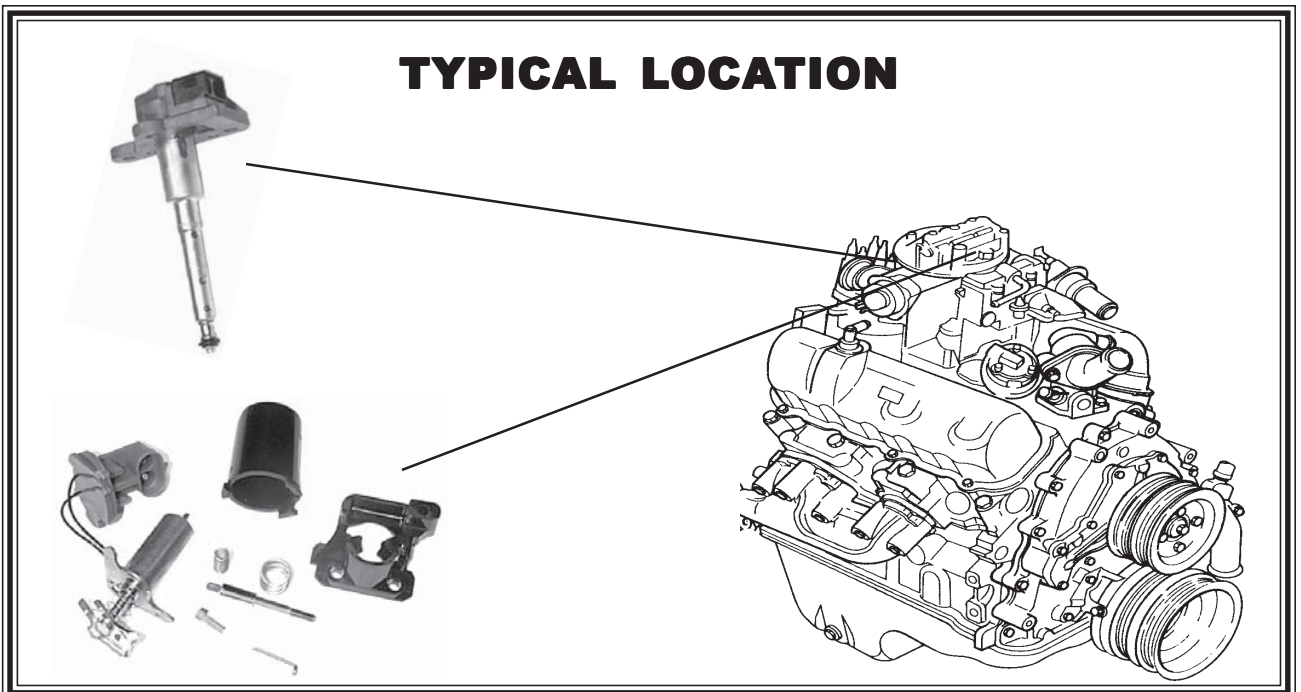

APPLICATION GUIDE

YEAR	ENGINE DISP.		O.E.M. NO.	CARBURETOR NO.	WALKER PART NO.
------	--------------	--	------------	----------------	-----------------

BUICK

4 CYLINDER

1982	1.8L (G)	112"	17066911, 17067586, 17111445	17081600, 601, 700, 701; 17082300, 301	318-1005
1981-80	2.5L (5)	151"	17066911, 17067586, 17111445	17081670, 671, 672, 673, 764, 766	318-1005

6 CYLINDER

1986-82	2.8L (L,X,Z,7)	173"	17066911, 17067586, 17111445	17082316, 317, 320, 321, 640, 641, 642; 17083450, 451, 452, 453, 454, 455, 456; 17084534, 535, 537, 538, 540	318-1005
1981	2.8L (L,X,Z,7)	173"	17066911, 17067586, 17111445	17081608, 610, 612, 614, 650, 651, 652, 653, 740, 742	318-1005
1980	2.8L	173"	17066911, 17067586, 17111445	17059760, 762, 763; 17080740, 742	318-1005
1985-82	3.0L (E)	181"	17067343, 344; 17111102	17082183, 186, 196; 17083193, 194, 196; 17084193, 194, 195	318-1001
1987-81	3.8L (A, 3, 8)	231"	17067343, 344; 17111102	17081191, 192, 242, 243; 17082182, 184, 192, 194, 242, 248, 249, 260; 17083190, 192, 242, 244; 17084191	318-1001
1980-79	3.8L (A, 3)	231"	17058167, 17063279	17080491, 493, 495, 496, 498, 540, 542, 543; 17081190, 193	318-1003
1984-81	4.1L (4)	252"	17067343, 344; 17111102	17081245, 247, 248, 249, 253, 254; 17082245, 246, 247, 248, 265, 266, 267, 268, 294, 295, 298, 299; 17084240, 244, 246	318-1001

8 CYLINDER

1981	4.3L (S)	265"	17067343, 344; 17111102		318-1001
1990-81	5.0L (H)	305"	17067343, 344; 17111102		318-1001
1990-81	5.0L (Y)	307"	17067343, 344; 17111102	17081245, 247, 248, 249, 253, 254, 289; 17082253, 17083250, 253; 17084252, 254, 256, 258	318-1001
1980	5.0L (H)	305"	17063279	17080502, 504, 516, 517	318-1003
1980	5.7L (R, X)	350"	17063279		318-1003

CADILLAC

4 CYLINDER

1982	1.8L (G)	112"	17066911, 17067586, 17111445	17081600, 606, 607, 701; 17082304, 305	318-1005
------	----------	------	---------------------------------	---	----------

6 CYLINDER

1982-81	4.1L (4)	252"	17067343, 344	17081248, 249, 17082246, 247, 266, 267, 295, 298	318-1001
---------	----------	------	---------------	---	----------

8 CYLINDER

1982-81	4.1L (4)	252"	17067343, 344; 17111102		318-1001
1990-86	5.0L (Y, 9)	307"	17067343, 344; 17111102		318-1001
1980	6.0L (9)	368"	17058167, 17063279	17080530	318-1003

CHEVROLET

4 CYLINDER

1985	1.0L (M)	61"	17066911, 17067586, 17111445		318-1005
1988-85	1.0L	61" (Sprint)	96051679		318-2032
1989-85	1.5L	92" (Spectrum)	94332796		318-2025
1988-85	1.5L (K, 7)	92"	94332796	94109561, 94130052, 94176394, 395; 94310950, 94325198, 199, 200, 201, 210, 211; 94426916, 917; 94451949, 950	318-2025
1981	1.6L (9)	98"	14039067		318-2036
1982	1.8L (G)	112"	17066911, 17067586, 17111445	17081600, 601, 606, 607; 17081700, 17082300, 301, 302, 304	318-1005

APPLICATION GUIDE

YEAR	ENGINE DISP.		O.E.M. NO.	CARBURETOR NO.	WALKER PART NO.
------	--------------	--	------------	----------------	-----------------

CHEVROLET

4 CYLINDER (CONT'D)

1981-79	2.5L (V, 5)	151"	17066911, 17067586, 17111445	17059714, 716, 718, 720, 721, 722, 723, 724, 774, 775, 776, 777; 17081670, 671, 672, 673, 764, 766	318-1005
---------	-------------	------	---------------------------------	--	----------

6 CYLINDER

1986-83	2.8L (X,Z,1,7)	173"	17066911, 17067586, 17111445	17083450, 451, 452, 453, 454, 455, 456; 17083630, 631, 632, 633; 17084534, 535, 537, 538	318-1005
1982-81	2.8L (X,Z,1,7)	173"	17066911, 17067586, 17111445	17081608, 610, 612, 614, 616, 618, 650, 651, 652, 653, 656, 657, 658, 740, 742; 17082316, 317, 321, 390, 391; 17082490, 491; 17082640, 641, 642	318-1005
1980	2.8L (X,Z,1,7)	173"	17066911, 17067586, 17111445	17059714, 716, 718, 720; 17080740, 042	318-1005
1987-81	3.8L (A, 3)	231"	17067343, 344; 17111102		318-1001
1984-81	3.8L (K, 9)	229"	17067343, 344; 17111102	17081133, 134, 136; 17082130, 132; 17084132	318-1001
1984-81	3.8L (K, 9)	231"	17067343, 344; 17111102	17081243, 17082182, 184, 192; 17084191	318-1001
1980	3.8L (K)	229"	17058167, 17063279	17080491, 493, 495, 496, 498, 543	318-1003
1980-79	3.8L (A, 3)	231"	17058167, 17063279		318-1003
1986	4.3L (N)	262"	17067343, 344	17086058	318-1001

8 CYLINDER

1982-81	4.4L (J)	267"	17067343, 344; 17111102	17081138, 140; 17082138, 140	318-1001
1990-81	5.0L (G, H)	305"	17067343, 344; 17111102	17087123, 130, 131, 306; 17088152	318-1001
1990-81	5.0L (Y)	307"	17067343, 344; 17111102		318-1001
1986-83	5.0L	305"	17067343, 344; 17111102	17083204, 207; 17084201, 204; 17085202, 204	318-1001
1984-82	5.0L (G, H)	305"	17066911, 17067586, 17111445		318-1005
1982-81	5.0L	305"		17081202, 204, 207, 216, 217, 218, 219, 222, 224, 228; 17082202, 203, 204, 216, 218	318-1001
1980	5.0L (H)	305"	17063279	17080493, 502, 504, 516, 517	318-1003
1986-81	5.7L (L, 6)	350"	17067343, 344; 17111102		318-1001

CHEVROLET/GMC TRUCK

6 CYLINDER

1985-82	2.8L (B)	173"	17066911, 17067586, 17111445	17082356, 357, 358, 359; 17083356, 357, 358, 359; 17084356, 357, 358, 359, 370; 17085356, 357, 358, 359, 368, 369, 370, 371	318-1005
1983-81	3.8L (K)	229", 231"	17067343, 344; 17111102		318-1001
1980	3.8L (K)	229", 231"S	17058167, 17063279		318-1003
1980-79	3.8L (A)	231"	17058167, 17063279		318-1003
1984-83	4.1L (D)	250"	17066911, 17067586, 17111445		318-1005
1986-85	4.3L (N)	262" (M/T)	17067343, 344; 17111102	17085502	318-1001

8 CYLINDER

1982-81	4.4L (J)	267"	17067343, 344; 17111102		318-1001
1984-81	5.0L (F, G, H)	305"	17067343, 344; 17111102	17083524, 526	318-1001
1980	5.0L (G, H)	305"	17063279		318-1003
1984-83	5.7L (L, M, P)	350"	17067343, 344; 17111102	17083506, 508; 17084507, 508	318-1001

CHRYSLER

8 CYLINDER

1987	5.2L (P)	318"	4342822, 882	(4 BBL)	318-1001
1985	5.2L (P, 4)	318"	4342822, 882	(4 BBL)	318-1001

APPLICATION GUIDE

YEAR	ENGINE DISP.		O.E.M. NO.	CARBURETOR NO.	WALKER PART NO.
------	-----------------	--	------------	----------------	--------------------

DODGE

4 CYLINDER

1990-87	1.5L	92" (Colt FWD)	MD612924		318-2034
1986-85	1.5L	92" (Colt)	MD612466		318-2035
1983-81	1.7L (A, B)	105"	4267112, 114, 115; 4293764, 765	R-9052, 053, 054, 055; 9497, 9822, 823, 824; 9937, 938	318-2037
1982-81	2.2L (B)	135"	4267112, 113, 114, 115; 4293713, 714, 764, 765	R-9060, 061, 062, 063; 9125, 126, 127, 128; 9602, 603, 604, 605, 650, 652, 653, 654; 9753, 9868, 869, 870, 871; 9940, 941, 942	318-2037

8 CYLINDER

1987-85	5.2L (P, 4)	318"	4342822, 882	(4 BBL)	318-1001
---------	-------------	------	--------------	---------	----------

DODGE TRUCK

4 CYLINDER

All	2.6L	160" (Raider)	MD612831		318-2033
-----	------	---------------	----------	--	----------

FORD

4 CYLINDER

1986-85	2.3L (A, R)	140"	E4PZ-9S565-C (C-1) (MCS)	E5ZE-9510-AA, AB, CA, CB; E6ZE-EA	318-2006
1983	2.3L (A, R)	140"	E4PZ-9S565-C (C-1) (MCS)	E3ZE-9510-ABA, ACA, ADA, AEA, APA, ARA, LA, MA, TC, UB, VA, YA	318-2006

6 CYLINDER

1982	3.8L	232"	D9AZ-9C908-A (FBA)	E2AE-9510-LB, E2DE-NA, SA, TA, UA, VA; E25E-FA, TA, UA	319-2021
------	------	------	--------------------	---	----------

8 CYLINDER

1982-81	4.2L	255"	D9AZ-9C908-A (FBA)	E1AE-9510-AA, ACA, KA; E1DE-AA, E2AE-ABA, RA; E2SE-DB, FA	319-2021
1982-81	5.0L	302"	D9AZ-9C908-A (FBA)	E1AE-9510-LA, SA; E2AE-AGA, MA, MB	319-2021
1980	5.0L	302"	D9AZ-9C908-A (FBA)	D9AE-9510-AZA, E0AE-AAA, AAB, ACA, ACB, ADA, ATA, ZA, ZB	319-2021
1991-89	5.8L	351"	D9AZ-9C908-A (FBA)	E8AE-9510-AA, F0AE-AA	319-2021
1988-87	5.8L	351" W	D9AZ-9C908-A (FBA)	E7AE-9510-AA, E8AE-AA	319-2021
	(Inc Canada)				
1987-82	5.8L	351" W	D9AZ-9C908-A (FBA)	E1AE-9510-AGA, E2AE-AJA, APA, NA	319-2021
1981-80	5.8L	351" W	D9AZ-9C908-A (FBA)	E0AE-9510-AHA, BA, BB, LA, LB, PA, PB; E1AE-AGA, MA, VA; E1VE-AA, E2PE-ALA	319-2021
1979	5.8L	351"	D9AZ-9C908-A (FBA)	D9AE-9510-ACA, BAA; D9PE-BCA	319-2021

FORD TRUCK

4 CYLINDER

1984-83	2.0L (C)	122"	E4PZ-9S565-C (C-1) (MCS)	E27E-9510-CB, CC; E37E-EA, EB, FA, FB	318-2006
1984	2.3L (A, 3)	140"	E4PZ-9S565-C (C-1) (MCS)	E37E-9510-BA, BB, LA, LB, NA, NB, RA, RB	318-2006
1983	2.3L (A, 3)	140"	E4PZ-9S565-C (C-1) (MCS)	E27E-9510-BB, EB, HB, TA; E37E-BA, BB, LA, LB, NA, NB, RA, RB	318-2006

8 CYLINDER

1982-81	5.0L	302"	D9AZ-9C908-A (FBA)	E1TE-9510-ABA, YA; E2TE-CAA, CBA, DFB, DGB, DKA, DLA	319-2021
1983	5.8L	351" W	D9AZ-9C908-A (FBA)	E2TE-9510-CCB, CCC, CDB, CDD; E3TE-BVA, BYA	319-2021
1982-81	5.8L	351" W	D9AZ-9C908-A (FBA)	E1TE-9510-AHA, ZA; E2TE-CCA, CCB, CCC, CDA, CDB, CDD	319-2021

APPLICATION GUIDE

YEAR	ENGINE DISP.		O.E.M. NO.	CARBURETOR NO.	WALKER PART NO.
GEO					
4 CYLINDER					
1989	1.5L (7)	92"	94332796	94310950, 94325198	318-2025
ISUZU					
4 CYLINDER					
1989-85	1.5L	92" (I-Mark)	94332796		318-2025
JEEP					
6 CYLINDER					
1986-84	2.8L (W)	173"	8133504, 89 83 501 037	17085006, 388; 17086081	318-1005
1986-84	4.2L (C)	258"	8133504, 89 83 501 037		318-1005
LINCOLN					
6 CYLINDER					
1982	3.8L	232"	D9AZ-9C908-A (FBA)	E25E-9510-ABA, AC, GA, SA	319-2021
8 CYLINDER					
1982	5.0L	302"	D9AZ-9C908-A (FBA)	E25E-9510-ABA, AC	319-2021
1980	5.8L	351" W	D9AZ-9C908-A (FBA)	E0AE-9510-BA, BB, PA, PB; E2PE-ALA	319-2021
MAZDA					
4 CYLINDER					
1993-88	2.2L	135"	F240-13-X33	F240-13-600, F241-13-600	318-2024
MERCURY					
4 CYLINDER					
1986-85	2.3L (A, R)	140"	E4PZ-9S565-C (C-1) (MCS)	E5ZE-9510-AA, AB, CA, CB; E6ZE-EA	318-2006
1983	2.3L (A, R)	140"	E4PZ-9S565-C (C-1) (MCS)	E3ZE-9510-ABA, ACA, ADA, AEA, APA, ARA, LA, MA, TC, UB, VA, YA	318-2006
6 CYLINDER					
1982	3.8L	232"	D9AZ-9C908-A (FBA)	E2AE-9510-LB, E2DE-NA, SA, TA, UA, VA; E25E-FA, TA, UA	319-2021
8 CYLINDER					
1982-81	4.2L	255"	D9AZ-9C908-A (FBA)	E1AE-9510-AA, ACA, KA; E1DE-AA, E2AE-ABA, RA; E2SE-DB, FA	319-2021
1982-81	5.0L	302"	D9AZ-9C908-A (FBA)	E1AE-9510-LA, SA; E2AE-AGA, MA, MB	319-2021
1980	5.0L	302"	D9AZ-9C908-A (FBA)	D9AE-9510-AZA, E0AE-AAA, AAB, ACA, ACB, ADA, ATA, ZA, ZB	319-2021
1991-89	5.8L	351"	D9AZ-9C908-A (FBA)	E8AE-9510-AA, F0AE-AA	319-2021
1988-87	5.8L (Inc Canada)	351" W	D9AZ-9C908-A (FBA)	E7AE-9510-AA, E8AE-AA	319-2021
1987-82	5.8L	351" W	D9AZ-9C908-A (FBA)	E1AE-9510-AGA, E2AE-AJA, APA, NA	319-2021
1981-80	5.8L	351" W	D9AZ-9C908-A (FBA)	E0AE-9510-AHA, BA, BB, LA, LB, PA, PB; E1AE-AGA, MA, VA; E1VE-AA, E2PE-ALA	319-2021
1979	5.8L	351"	D9AZ-9C908-A (FBA)	D9AE-9510-ACA, BAA; D9PE-BCA	319-2021
NISSAN					
4 CYLINDER					
1987	1.6L	97"(Sentra)	16197-61A00, GV113-27		318-2030
1987	1.6L	97"(Sentra)	16197-61A03, GV113-26		318-2031
1986-82	1.6L (Pulsar, Stanza)	97"	16102-31M00, 31M10; GV113-6A, 6B		318-2029
1986-85	2.4L (Z24)	147"(Pickup)	GV113-20		318-2027
1984	2.4L (Z24)	147"(Pickup)	GV113-5		318-2028

APPLICATION GUIDE

YEAR	ENGINE DISP.		O.E.M. NO.	CARBURETOR NO.	WALKER PART NO.
------	-----------------	--	------------	----------------	--------------------

OLDSMOBILE
4 CYLINDER

1982	1.8L (G)	112"	17066911, 17067586, 17111445	17081600, 601, 606, 701; 17082300, 301, 304,	318-1005
1981-79	2.5L (V, 5)	151"	17066911, 17067586, 17111445	17059714, 716, 718, 721, 722, 723, 724, 774, 775, 776, 777; 17081670, 671, 672, 673, 764, 766	318-1005

6 CYLINDER

1986-81	2.8L (X, Z)	173"	17066911, 17067586, 17111445	17081608, 610, 612, 614, 650, 651, 652, 653, 740, 742; 17082316, 317, 320, 321, 640, 641, 642; 17083450, 451, 452, 453, 454, 455, 456; 17084534, 535, 537, 538, 540	318-1005
1980	2.8L	173"	17066911, 17067586, 17111445	17059760, 762, 763; 17080740, 742	318-1005
1985-84	3.0L (E)	181"	17067343, 344; 17111102	17084193	318-1001
1984-82	3.0L (E)	181"	17067343, 344; 17111102	17082183, 186, 196; 17083193, 194, 196; 17084193, 194, 195	318-1001
1987-81	3.8L (A)	231"	17067343, 344; 17111102	17081191, 192, 194, 197, 198, 199; 17082182, 184, 192, 194; 17083190, 192; 17083242, 244; 17084191	318-1001
1980-79	3.8L (A, 2)	231"	17058167, 17063279	17080491, 493, 495, 496, 498	318-1003
1984-81	4.1L (4)	252"	17067343, 344; 17111102	17081248, 289; 17082246, 247, 248, 265, 266, 267, 268, 294, 295, 298, 299; 17084240, 244, 246	318-1001

8 CYLINDER

1982-81	4.3L (F)	260"	17067343, 17111102	17081150, 17082150	318-1001
1980	4.3L	260"	17063279	17080454	318-1003
1990-81	5.0L (H)	305"	17067343, 344; 17111102		318-1001
1990-81	5.0L (Y)	307"	17067343, 344; 17111102	17081253, 254; 17082253, 17083250, 253; 17084252, 254, 256, 258; 17085554	318-1001
1980	5.0L (H)	305"	17063279	17080517	318-1003
1980	5.7L (R)	350"	17063279	17080553, 554	318-1003

PLYMOUTH
4 CYLINDER

1983-81	1.7L (A, B)	105"	4267112, 114, 115; 4293764, 765	R-9052, 053, 054, 055; 9497, 9822, 823, 824; 9937, 938	318-2037
1982-81	2.2L (B)	135"	4267112, 113, 114, 115; 4293713, 714, 764, 765	R-9060, 061, 062, 063; 9125, 126, 127, 128; 9602, 603, 604, 605, 650, 652, 653, 654; 9753, 9868, 869, 870, 871; 9940, 941, 942	318-2037

8 CYLINDER

1987-85	5.2L (P, 4)	318"	4342822, 882	(4 BBL)	318-1001
---------	-------------	------	--------------	---------	----------

PONTIAC
4 CYLINDER

1981	1.6L (9)	98"	14039067		318-2036
1982	1.8L (G)	112"	17066911, 17067586, 17111445	17059327, 17082300, 301, 303, 304	318-1005
1981-79	2.5L (R)	151"	17066911, 17067586, 17111445	17058724, 17059714, 716, 718, 720, 721, 722, 723, 724, 774, 775, 776, 777; 17081670, 671, 672, 673, 764, 766	318-1005

APPLICATION GUIDE

YEAR	ENGINE DISP.	O.E.M. NO.	CARBURETOR NO.	WALKER PART NO.
------	-----------------	------------	----------------	--------------------

PONTIAC

6 CYLINDER

1986-80	2.8L(L,X,Z,1,7)173"	17066911, 17067586, 17111445	17059740, 742, 760, 762, 763; 17080740, 742; 17081610, 614, 650, 651, 652, 653, 740, 742; 17082316, 317, 320, 321, 390, 391, 490, 491, 640, 641, 642; 17083450, 451, 452, 453, 454, 455, 456, 630, 631, 632, 633, 634, 635, 636, 650; 17084534, 535, 537, 538, 540; 17084632, 633, 635, 636	318-1005
---------	---------------------	---------------------------------	--	----------

6 CYLINDER

1987-81	3.8L (A)	231"	17067343, 344; 17111102	17081191, 194, 196, 197, 198, 199, 243; 17082182, 184, 192; 17084191	318-1001
1983-81	3.8L (K, 9)	229"	17067343, 344; 17111102	17081133, 134, 136; 17082130, 132; 17084132	318-1001
1980-79	3.8L (A, K, 2)	231"	17058167, 17063279		318-1003
1980	3.8L	231"		17080493, 495, 496, 498; 17081190, 193	318-1003
1982	4.1L	252"		17087248	318-1001

8 CYLINDER

1981	4.3L (S)	265"	17067343, 344; 17111102	17081150, 160	318-1001
1981	4.9L (W)	301"	17067343, 344; 17111102	17081270, 272, 273	318-1001
1990-81	5.0L (H)	305", 307"	17067343, 344; 17111102	17059320, 321, 322; 17081203, 207; 17082202, 203, 204, 207; 17083204, 205, 207; 17084201, 204, 205, 208, 209; 17085203, 204, 207; 17086004, 005, 040; 17087130, 131, 306	318-1001
1990-81	5.0L (Y)	307"	17067343, 344; 17111102	17059321, 17081254	318-1001
1980	5.0L (H)	305"	17063279	17080504, 517	318-1003
1980	5.7L (X)	350"	17063279	17080553	318-1003

SUZUKI

4 CYLINDER

1989-86	1.0L (Samurai, Sidekick)	61"	13240-83050		318-2032
---------	-----------------------------	-----	-------------	--	----------

O.E.M INTERCHANGE

O.E.M. PART NO.	WALKER PART NO.	O.E.M. PART NO.	WALKER PART NO.	O.E.M. PART NO.	WALKER PART NO.	O.E.M. PART NO.	WALKER PART NO.
AMC/JEEP		FORD (CONT'D)		FORD (CONT'D)		G.M. (CONT'D)	
MCS PART NO.		FBA CARBURETOR NO.		FBA CARBURETOR NO.		CARBURETOR NO.	
8133504	318-1005	D9AE-9510-ACA	319-2021	E25E-9510-GA	319-2021	17058724	318-1005
89 83 501 037	318-1005	D9AE-9510-AZA	319-2021	E25E-9510-SA	319-2021	17059320	318-1001
CARBURETOR NO.		D9AE-9510-BAA	319-2021	E25E-9510-TA	319-2021	17059321	318-1001
17085006	318-1005	D9PE-9510-BCA	319-2021	E25E-9510-UA	319-2021	17059322	318-1001
17085388	318-1005	E0AE-9510-AAA	319-2021	E3TE-9510-BVA	319-2021	17059327	318-1005
17086081	318-1005	E0AE-9510-AAB	319-2021	E3TE-9510-BYA	319-2021	17059714	318-1005
CHRYSLER		E0AE-9510-ACA	319-2021	E7AE-9510-AA	319-2021	17059716	318-1005
MCS PART NO.		E0AE-9510-ACB	319-2021	E8AE-9510-AA	319-2021	17059718	318-1005
4267112	318-2037	E0AE-9510-ADA	319-2021	F0AE-9510-AA	319-2021	17059720	318-1005
4267113	318-2037	E0AE-9510-AHA	319-2021	MCS PART NO.		17059721	318-1005
4267114	318-2037	E0AE-9510-ATA	319-2021	E4PZ-9S565-C	318-2006	17059722	318-1005
4267115	318-2037	E0AE-9510-BA	319-2021	MCS CARBURETOR NO.		17059723	318-1005
4293713	318-2037	E0AE-9510-BB	319-2021	E27E-9510-BB	318-2006	17059724	318-1005
4293714	318-2037	E0AE-9510-LA	319-2021	E27E-9510-CB	318-2006	17059740	318-1005
4293764	318-2037	E0AE-9510-LB	319-2021	E27E-9510-CC	318-2006	17059742	318-1005
4293765	318-2037	E0AE-9510-PA	319-2021	E27E-9510-EB	318-2006	17059760	318-1005
4342822	318-1001	E0AE-9510-PB	319-2021	E27E-9510-HB	318-2006	17059762	318-1005
4342882	318-1001	E0AE-9510-ZA	319-2021	E27E-9510-TA	318-2006	17059763	318-1005
MD612466	318-2035	E0AE-9510-ZB	319-2021	E3ZE-9510-ABA	318-2006	17059774	318-1005
MD612831	318-2033	E1AE-9510-AA	319-2021	E3ZE-9510-ACA	318-2006	17059775	318-1005
MD612924	318-2034	E1AE-9510-ACA	319-2021	E3ZE-9510-ADA	318-2006	17059776	318-1005
CARBURETOR NO.		E1AE-9510-AGA	319-2021	E3ZE-9510-ACA	318-2006	17059777	318-1005
R-9052	318-2037	E1AE-9510-KA	319-2021	E3ZE-9510-ADA	318-2006	17080454	318-1003
R-9053	318-2037	E1AE-9510-LA	319-2021	E3ZE-9510-AEA	318-2006	17080491	318-1003
R-9054	318-2037	E1AE-9510-MA	319-2021	E3ZE-9510-APA	318-2006	17080493	318-1003
R-9055	318-2037	E1AE-9510-SA	319-2021	E3ZE-9510-ARA	318-2006	17080495	318-1003
R-9060	318-2037	E1AE-9510-VA	319-2021	E3ZE-9510-LA	318-2006	17080496	318-1003
R-9061	318-2037	E1DE-9510-AA	319-2021	E3ZE-9510-MA	318-2006	17080498	318-1003
R-9062	318-2037	E1TE-9510-ABA	319-2021	E3ZE-9510-TC	318-2006	17080502	318-1003
R-9063	318-2037	E1TE-9510-AHA	319-2021	E3ZE-9510-UB	318-2006	17080504	318-1003
R-9125	318-2037	E1TE-9510-YA	319-2021	E3ZE-9510-VA	318-2006	17080516	318-1003
R-9126	318-2037	E1TE-9510-ZA	319-2021	E3ZE-9510-VA	318-2006	17080517	318-1003
R-9127	318-2037	E1VE-9510-AA	319-2021	E3ZE-9510-YA	318-2006	17080517	318-1003
R-9128	318-2037	E2AE-9510-ABA	319-2021	E37E-9510-BA	318-2006	17080530	318-1003
R-9497	318-2037	E2AE-9510-AGA	319-2021	E37E-9510-BB	318-2006	17080540	318-1003
R-9497	318-2037	E2AE-9510-AGA	319-2021	E37E-9510-EA	318-2006	17080542	318-1003
R-9602	318-2037	E2AE-9510-AJA	319-2021	E37E-9510-EB	318-2006	17080542	318-1003
R-9603	318-2037	E2AE-9510-APA	319-2021	E37E-9510-FA	318-2006	17080543	318-1003
R-9604	318-2037	E2AE-9510-LB	319-2021	E37E-9510-FA	318-2006	17080553	318-1003
R-9605	318-2037	E2AE-9510-LA	319-2021	E37E-9510-FB	318-2006	17080554	318-1003
R-9650	318-2037	E2AE-9510-MA	319-2021	E37E-9510-LA	318-2006	17080740	318-1005
R-9652	318-2037	E2AE-9510-MA	319-2021	E37E-9510-LA	318-2006	17080742	318-1005
R-9653	318-2037	E2AE-9510-MB	319-2021	E37E-9510-LB	318-2006	17080742	318-1005
R-9654	318-2037	E2AE-9510-NA	319-2021	E37E-9510-LB	318-2006	17081133	318-1001
R-9753	318-2037	E2AE-9510-NA	319-2021	E37E-9510-NA	318-2006	17081134	318-1001
R-9822	318-2037	E2AE-9510-RA	319-2021	E37E-9510-NA	318-2006	17081136	318-1001
R-9823	318-2037	E2DE-9510-NA	319-2021	E37E-9510-NB	318-2006	17081136	318-1001
R-9824	318-2037	E2DE-9510-SA	319-2021	E37E-9510-RB	318-2006	17081138	318-1001
R-9868	318-2037	E2DE-9510-TA	319-2021	E5ZE-9510-AA	318-2006	17081140	318-1001
R-9869	318-2037	E2DE-9510-UA	319-2021	E5ZE-9510-AB	318-2006	17081150	318-1001
R-9870	318-2037	E2DE-9510-VA	319-2021	E5ZE-9510-AB	318-2006	17081150	318-1001
R-9871	318-2037	E2PE-9510-ALA	319-2021	E5ZE-9510-CA	318-2006	17081160	318-1001
R-9937	318-2037	E2SE-9510-DB	319-2021	E5ZE-9510-CB	318-2006	17081190	318-1003
R-9938	318-2037	E2SE-9510-DB	319-2021	E6ZE-9510-EA	318-2006	17081191	318-1001
R-9940	318-2037	E2SE-9510-FA	319-2021	G.M.		17081192	318-1001
R-9941	318-2037	E2TE-9510-CAA	319-2021	MCS PART NO.		17081193	318-1003
R-9942	318-2037	E2TE-9510-CBA	319-2021	14039067	318-2036	17081194	318-1001
FORD		E2TE-9510-CCA	319-2021	17058167	318-1003	17081196	318-1001
FBA PART NO.		E2TE-9510-CCB	319-2021	17063279	318-1003	17081197	318-1001
D9AZ-9C908-A	319-2021	E2TE-9510-CCD	319-2021	17066911	318-1005	17081198	318-1001
		E2TE-9510-CDB	319-2021	17067343	318-1001	17081199	318-1001
		E2TE-9510-CDD	319-2021	17067344	318-1001	17081202	318-1001
		E2TE-9510-DFB	319-2021	17067586	318-1005	17081203	318-1001
		E2TE-9510-DGB	319-2021	17067586	318-1005	17081204	318-1001
		E2TE-9510-DKA	319-2021	17068611	318-1005	17081207	318-1001
		E2TE-9510-DLA	319-2021	17111102	318-1001	17081207	318-1001
		E25E-9510-ABA	319-2021	17111445	318-1005	17081216	318-1001
		E25E-9510-AC	319-2021	94332796	318-2025	17081217	318-1001
		E25E-9510-FA	319-2021	96051679	318-2032	17081218	318-1001
						17081219	318-1001
						17081222	318-1001

O.E.M INTERCHANGE

O.E.M. PART NO.	WALKER PART NO.	O.E.M. PART NO.	WALKER PART NO.	O.E.M. PART NO.	WALKER PART NO.	O.E.M. PART NO.	WALKER PART NO.
G.M. (CONT'D)		G.M. (CONT'D)		G.M. (CONT'D)		G.M. (CONT'D)	
CARBURETOR NO.		CARBURETOR NO.		CARBURETOR NO.		CARBURETOR NO.	
17081224	318-1001	17082253	318-1001	17083650	318-1005	94325200	318-2025
17081228	318-1001	17082260	318-1001	17084132	318-1001	94325201	318-2025
17081242	318-1001	17082265	318-1001	17084191	318-1001	94325210	318-2025
17081243	318-1001	17082266	318-1001	17084193	318-1001	94325211	318-2025
17081245	318-1001	17082267	318-1001	17084194	318-1001	94426916	318-2025
17081247	318-1001	17082268	318-1001	17084195	318-1001	94426917	318-2025
17081248	318-1001	17082294	318-1001	17084201	318-1001	94451949	318-2025
17081249	318-1001	17082295	318-1001	17084204	318-1001	94451950	318-2025
17081253	318-1001	17082298	318-1001	17084205	318-1001		
17081254	318-1001	17082299	318-1001	17084208	318-1001		
17081270	318-1001	17082300	318-1005	17084209	318-1001		
17081272	318-1001	17082301	318-1005	17084240	318-1001		
17081273	318-1001	17082302	318-1005	17084244	318-1001		
17081289	318-1001	17082303	318-1005	17084246	318-1001		
17081600	318-1005	17082304	318-1005	17084252	318-1001		
17081601	318-1005	17082305	318-1005	17084254	318-1001		
17081606	318-1005	17082316	318-1005	17084256	318-1001		
17081607	318-1005	17082317	318-1005	17084258	318-1001		
17081608	318-1005	17082320	318-1005	17084356	318-1005		
17081610	318-1005	17082321	318-1005	17084357	318-1005		
17081612	318-1005	17082356	318-1005	17084358	318-1005		
17081614	318-1005	17082357	318-1005	17084359	318-1005		
17081616	318-1005	17082358	318-1005	17084370	318-1005		
17081618	318-1005	17082359	318-1005	17084507	318-1001		
17081650	318-1005	17082390	318-1005	17084508	318-1001		
17081651	318-1005	17082391	318-1005	17084534	318-1005		
17081652	318-1005	17082490	318-1005	17084535	318-1005		
17081653	318-1005	17082491	318-1005	17084537	318-1005		
17081656	318-1005	17082640	318-1005	17084538	318-1005		
17081657	318-1005	17082641	318-1005	17084540	318-1005		
17081658	318-1005	17082642	318-1005	17084632	318-1005		
17081670	318-1005	17083190	318-1001	17084633	318-1005		
17081671	318-1005	17083192	318-1001	17084635	318-1005		
17081672	318-1005	17083193	318-1001	17084636	318-1005		
17081673	318-1005	17083194	318-1001	17085202	318-1001		
17081700	318-1005	17083196	318-1001	17085203	318-1001		
17081701	318-1005	17083204	318-1001	17085204	318-1001		
17081740	318-1005	17083205	318-1001	17085207	318-1001		
17081742	318-1005	17083207	318-1001	17085356	318-1005		
17081764	318-1005	17083242	318-1001	17085357	318-1005		
17081766	318-1005	17083244	318-1001	17085358	318-1005		
17082130	318-1001	17083250	318-1001	17085359	318-1005		
17082132	318-1001	17083253	318-1001	17085368	318-1005		
17082138	318-1001	17083356	318-1005	17085369	318-1005		
17082140	318-1001	17083357	318-1005	17085370	318-1005		
17082150	318-1001	17083358	318-1005	17085371	318-1005		
17082182	318-1001	17083359	318-1005	17085502	318-1001		
17082183	318-1001	17083450	318-1005	17085554	318-1001		
17082184	318-1001	17083451	318-1005	17086004	318-1001		
17082186	318-1001	17083452	318-1005	17086005	318-1001		
17082192	318-1001	17083453	318-1005	17086040	318-1001		
17082194	318-1001	17083454	318-1005	17086058	318-1001		
17082196	318-1001	17083455	318-1005	17087123	318-1001		
17082202	318-1001	17083456	318-1005	17087130	318-1001		
17082203	318-1001	17083506	318-1001	17087131	318-1001		
17082204	318-1001	17083508	318-1001	17087248	318-1001		
17082207	318-1001	17083524	318-1001	17087306	318-1001		
17082216	318-1001	17083526	318-1001	17088152	318-1001		
17082218	318-1001	17083630	318-1005	94109561	318-2025		
17082242	318-1001	17083631	318-1005	94130052	318-2025		
17082245	318-1001	17083632	318-1005	94176394	318-2025		
17082246	318-1001	17083633	318-1005	94176395	318-2025		
17082247	318-1001	17083634	318-1005	94310950	318-2025		
17082248	318-1001	17083635	318-1005	94325198	318-2025		
17082249	318-1001	17083636	318-1005	94325199	318-2025		
						ISUZU	
						MCS PART NO.	
						8-94332-796-0	318-2025
						CARBURETOR NO.	
						8-94109-561-0	318-2025
						8-94130-052-0	318-2025
						8-94130-950-0	318-2025
						8-94130-951-0	318-2025
						8-94176-394-0	318-2025
						8-94176-395-0	318-2025
						8-94325-198-0	318-2025
						8-94325-199-0	318-2025
						8-94426-916-0	318-2025
						8-94426-917-0	318-2025
						8-94451-949-0	318-2025
						8-94451-950-0	318-2025
						MAZDA	
						MCS PART NO.	
						F240-13-X33	318-2024
						CARBURETOR PART NO.	
						F240-13-600	318-2024
						F241-13-600	318-2024
						NISSAN	
						MCS PART NO.	
						16102-31M00	318-2029
						16102-31M10	318-2029
						16197-61A00	318-2030
						16197-61A03	318-2031
						GV113-26	318-2031
						GV113-27	318-2030
						GV113-5	318-2028
						GV113-6A	318-2029
						GV113-6B	318-2029
						SUZUKI	
						MCS PART NO.	
						13240-83050	318-2032



318-1001

BUICK (6, 8) 1981-90
 CADILLAC (6, 8) 1986-90
 CHEVROLET (6, 8) 1981-90
 CHEV/GMC TRUCK (6, 8) 1981-86
 CHRYSLER (8) 1985-87
 DODGE (8) 1985-87
 OLDSMOBILE (6, 8) 1981-90
 PLYMOUTH (8) 1985-88
 PONTIAC (6, 8) 1981-90



318-2002
 CARTER #213-150
 PULSE SOLENOID



318-2019
 MIKUNI #MD612006
 SOLENOID VALVE



318-2020
 MIKUNI #MD612014
 SOLENOID VALVE

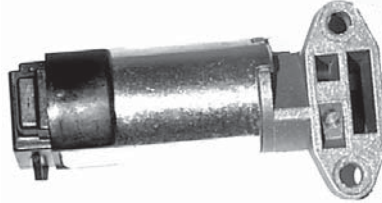

318-2006
 FORD (4) 1983-86
 FORD TRUCK (4) 1983-84
 MERCURY (4) 1983-85



318-2021
 MIKUNI #MD612807
 SOLENOID VALVE



318-1003

BUICK (6, 8) 1979-80
 CADILLAC (8) 1980
 CHEVROLET (6, 8) 1979-80
 CHEV/GMC TRUCK (6, 8) 1979-80
 OLDSMOBILE (6, 8) 1979-80
 PONTIAC (6, 8) 1979-80



318-2012
 MIKUNI
 JET AIR CONTROL SOLENOID



318-2022
 MIKUNI
 FEEDBACK SOLENOID

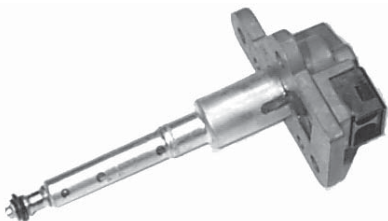

318-1005

BUICK (4, 6) 1980-86
 CADILLAC (4) 1982
 CHEVROLET (4, 6, 8) 1979-86
 CHEV/GMC TRUCK (6) 1982-85
 JEEP (6) 1984-86
 OLDSMOBILE (4, 6) 1980-86
 PONTIAC (4, 6) 1980-86



318-2017
 MIKUNI
 SOLENOID VALVE



318-2018
 MIKUNI #MD612434
 SOLENOID VALVE



318-2023
 MIKUNI #MD612072
 SOLENOID VALVE

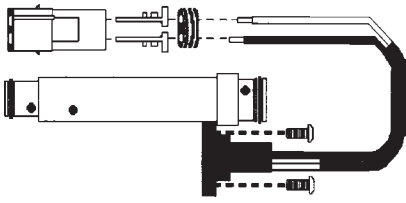

318-2024
MAZDA (4) 1988-93

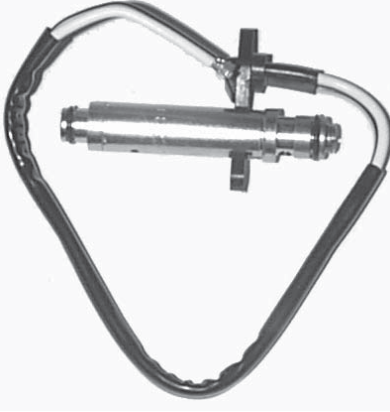

318-2029
NISSAN (4) 1982-86



318-2033
DODGE TRUCK (4) All



318-2025
CHEVROLET (4) 1985-89
GEO (4) 1989
ISUZU (4) 1985-89



318-2030
NISSAN (4) 1987



318-2034
DODGE (4) 1987-90



318-2027
NISSAN (4) 1985-86



318-2031
NISSAN (4) 1987



318-2035
DODGE (4) 1985-86



318-2028
NISSAN (4) 1984



318-2032
CHEVROLET (4) 1985-88
SUZUKI (4) 1986-89



318-2036
CHEVROLET (4) 1981
PONTIAC (4) 1981



318-2037
DODGE (4) 1981-83
PLYMOUTH (4) 1981-83

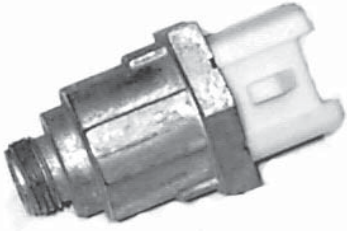

319-2021
FORD (6, 8) 1979-90
FORD TRUCK (8) 1981-83
LINCOLN (6, 8) 1980, 82
MERCURY (6, 8) 1979-90